

Stratos connectors

Hx1080 Series

Productsheet
Stratos Hx1080 Series

V1.0, 17-05-2016

Contact

In case of any questions,
call us on +31 (0)416-387700 or
sent an email to:
sales@simacelectronics.nl.

We like to help you!



Stratos Hx1080 Series

The HX-1080 Series HD & SD TV non-contact connectors. These Hybrid fiber/electrical connectors are backed by more than 25 years of experience with expanded beam (EB) fiber connector technology and are already the performance bench-mark in military harsh environment tactical applications where reliability and consistent field performance are a given.

In support of the deployment of HDTV and progressing from the limitations of legacy fiber contacting connector interfaces, Stratos has drawn on its unique experience for the development of the HX-1080 Broadcast Series. With world leading single mode EB optical performance using protected lensed fibers, the Stratos HX-1080 is designed to meet and exceed the generic requirements of the SMPTE specifications. On cameras at Studio or OB locations, Stratos HX-1080 Series connectors provide a solution that will work first time and every time. Offering unrivalled performance and versatility with low cost de-skilled field re-instatement solutions, and World-Wide support to HX-1080 are now set to become the new bench-mark for hybrid connectors in the challenging Broadcast environment.

Features

- Rugged Hermaphroditic
- Adapter Free Deployment
- SMPTE Compatible
- High Performance
- Easy Clean Interface
- Non-contact Optics
- High Reliability/Durability
- IP 67 Sealing

Stratos Expanded Beam

Highly reliable

Cost-effective

Designed for harsh environment

Stratos connectors

Hx1080 Series

Optical

Insertion Loss	Hx1080 S/M: -1.5dB maximum Hx1080 S/M: -1.2dB maximum
Return Loss	Hx1080 S/M: > 45dB

Mechanical

Durability	2000 Matings minimum
Free Fall Resistance	500 Falls from 1.2m height
Crush Resistance	>3kN
Cable Retention	1000N (Cable Dependant)

Electrical

Power Supply	2 Cores 20AWG
Controls	2 Cores 24AWG

Enviromental

Operating Temperature	-40°C to +85°C
Storage Temperature	-55°C to +85°C

Ordering Information

CON06376	Hx1080 Hybrid S/M Plug
CON06366	Hx1080 Hybrid S/M Flange Mount Bulkhead
CON06675	Hx1080 Hybrid S/M Flange Mount Bulk (SMPTE Cable Rear)
CON10310	Hx1080 Hybrid M/M Plug
CON10315	Hx1080 Hybrid M/M Flange Mount Bulkhead
CON10311	Hx1080 Hybrid M/M Flange Mount Bulkhead (SMPTE Cable Rear)

Stratos connectors

Hx1080 Series

Drawings

Plug Connector and Bulkhead



Bulkhead Connector D

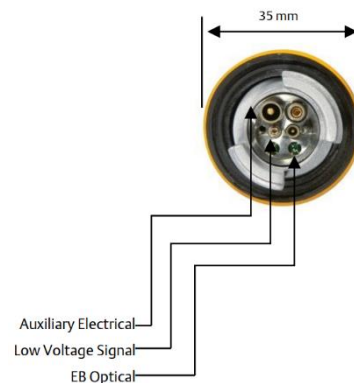

Bulkhead Panel mount detail

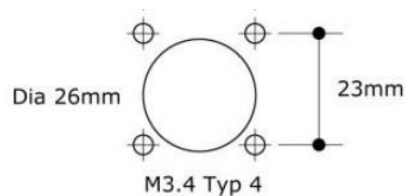

More information

Check www.simacelectronics.nl or call us on +31 (0) 416 387 711. We like to help you!